

Instructions

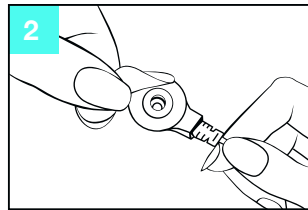

Step One

Important: Wash and gently pat your skin dry. Make sure the skin around your eyes is completely clean and dry before applying treatment patches.



Step Two

Remove the Activator Pod and peel off the small, round protective seal from one of the buds. Do not discard the seal; keep handy and reapply to either bud after treatment (see Step 8).

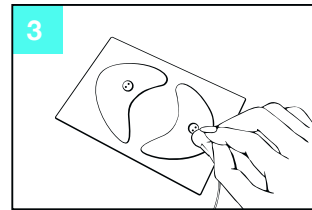

Step Three

Open a treatment pouch. Remove the patches from pouch (keep them on the liner) and place on a firm, flat surface. Snap the Activator Pod buds onto each patch.

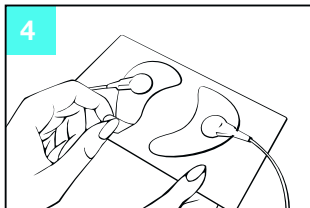

Step Four

Peel off one patch from liner. Leave the other patch on the liner until ready to apply.

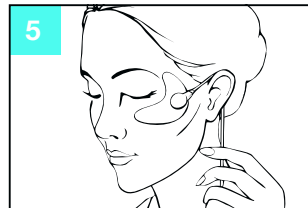

Step Five

Apply and position patches as shown in the next two illustrations and press gently onto skin. Be sure all edges adhere to the skin. Tuck the Activator Pod cords behind your ears.

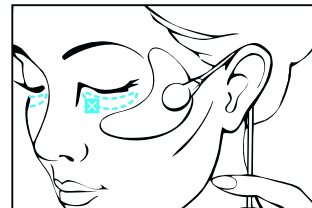

Important: Apply patches carefully so they do not cover the lower eyelids.

The skin in this lower lid area is very thin and delicate, and should not be treated with patches.



Important (continued)

Place patches approximately a pinky-fingertip away from the corner of the eye. It is not necessary for patches to completely cover wrinkles at the corner of the eye; treatment will still benefit this area.

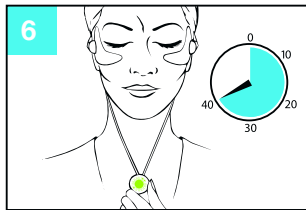

Step Six

Clip the Activator Pod onto clothing. When both patches make contact with the skin, the Activator Pod light will turn green and blink continuously throughout the treatment. After 40 minutes, the light will flash red and turn off, indicating treatment is complete.

7 | Remove Patches

Step Seven

Be gentle! Patches are sticky. Remove them slowly to avoid excessive pulling on your skin. Hold skin taut. Lift from the side closest to the nose and gently peel off toward the side of the face.

8 | After Treatment

Step Eight

Unsnap and discard patches. Replace the protective seal saved from Step 2 onto either one of the Activator Pod buds. (Note: Only one seal is included and needed.) Keep the Activator Pod protected in its pouch for future treatments.

Precautions

The WrinkleMD Eye System is specially designed for the area around the eyes. Use only as directed. Check with your physician before using if you are pregnant, have a pacemaker or similar device, are epileptic, wear metal braces on your teeth, or have a metal implant. Do not use over an area with broken capillaries or over an inflamed or open wound.

A Boost for Your Beauty Regimen

First Two Weeks: Quick-start a younger look with an intensive 2-week power treatment, using the patches twice a week for the first 2 weeks. Allow 3 to 4 days between patch treatments.

After Week Two: Maintain your youthful look by using the patch treatments once a week, along with your favorite beauty regimen.

Activator Pod Lights

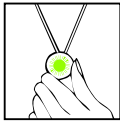

Beginning of Treatment

- Once both patches adhere to skin, a green light will flash for a few seconds and treatment will begin.
- The green light will blink slowly throughout treatment.
- After 40 minutes, the green light flashes red, indicating treatment is complete.
- The Activator Pod will turn off until next treatment.

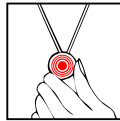

Interruption During Treatment

- If at any time during the treatment the Activator Pod buds are detached, a red light will appear and flash rapidly for five minutes.
- You will have five minutes to reconnect the buds in order to complete the 40-minute treatment.
- If the buds are disconnected for longer than five minutes, the Activator Pod will reset for the next 40-minute treatment.

Need Assistance with Your Activator Pod?

Contact our Customer Service team at **1.855.299.8800** and we'll be happy to help.

Do Not Open the Activator Pod.

The battery cannot be replaced. The pod contains no reusable products. Do not recharge, puncture, modify, dispose in fire or trash incinerator, or heat above 212 °F (100 °C). Do not submerge in water.

WARNING: Keep the Activator Pod and patches out of reach of children.

Do not disassemble the Activator Pod. The 3v battery contains Perchlorate. Do not put battery in mouth. Ingestion may cause choking or serious harm within two hours. If swallowed, contact physician or local poison control center immediately.